



# AD Series and CO Series

Lever and cylinder  
compatibility



## Overview

AD Series and CO Series electronic locks come standard with the Schlage® 6-pin Everest 29™ S123 keyway and two patented keys. The Everest 29 keyway's new, patent-protected undercut design with protection through 2029, is available in open and restricted keyway families. Patented restricted keyways, such as the Everest 29 R & T families, deliver a higher level of security that require authorization to access blanks for duplication. With the inclusion of the Primus XP feature, multiple levels of security ensure that you get the right solution throughout your facility or campus. The new Everest 29 patent enables a key blank that is backwards compatible to legacy Everest keyways allowing Everest 29 keys to work with existing Everest systems aiding the key system migration process.

The AD Series and CO Series can also be ordered with other popular Schlage keyways or prepared to receive Falcon® 6 and 7 pin standard key-in-lever cylinders. Less cylinder options are available to provide compatibility with standard, FSIC or SFIC cylinders of other manufacturers including, Sargent®, Corbin Russwin®, Medeco® and Yale®.

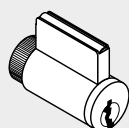

Full Cylinder  
PD LD  
LD SAR LD FA7

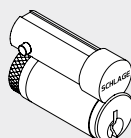

Full Size  
Interchangeable Core  
RD JD JD SAR  
JD CO6 JD CO7 JD MED  
JD YA6 YD YA7

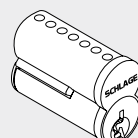

Small Format  
Interchangeable Core  
GD BD

## Features and benefits

- Multiple credential reader options including keypad, proximity, magnetic stripe, multi-technology<sup>1</sup>
- Wide variety of finishes and lever styles
- Cylindrical, mortise, mortise deadbolt and exit trim options available
- Compatible with most standard, FSIC or SFIC keyways from major brands of master key systems
- AD and CO 993 exit trim is compatible with a variety of exit devices including rim style from Von Duprin, Falcon, Sargent®, Precision™, Corbin Russwin®, Dorma® and Yale®

<sup>1</sup> Multi-technology readers available on AD Series only.

## Lever and cylinder compatibility

Part number	Description	With cylinder	Pins	Cylinder type			Lever style				Lever material by chassis type		
				KIL	FSIC	SFIC	RHO	SPA	TLR	ATH	CY	MS	Exit
PD	Schlage® - Everest 29™ S123 (standard)	x	6	x			x	x	x	x	Zinc	Steel	Steel
LD	Schlage, Falcon®		6	x			x	x	x	x	Zinc	Steel	Steel
RD	Schlage - Everest 29 S123 (standard)	x	6		x		x	x	x	x	Zinc	Steel	Steel
JD	Schlage		6		x		x	x	x	x	Zinc	Steel	Steel
GD	Schlage Everest 29 R Family Keyways	x	7			x	x	x	x	x	Zinc	Zinc	Zinc
BD	Schlage, Falcon, Competitive OEM's		7			x	x	x	x	x	Zinc	Zinc	Zinc
LD FA7	Falcon		7	x			x	x			Zinc	Steel	Steel
LD SAR	Sargent® (10L+11L)		6	x			x	x	x	x	Zinc	Steel	Steel
JD SAR	Sargent 6300		6		x		x	x	x	x	Zinc	Steel	Steel
JD CO6	Corbin® 8000		6		x		x	x	x	x	Zinc	Steel	Steel
JD CO7	Corbin 8000-7		7		x		x	x	x		Zinc	Steel	Steel
JD MED	Medeco® 32*0201		6		x		x	x			Steel	Steel	Steel
JD YA6	Yale® 1210 or Medeco 31*0100		6		x		x	x	x	x	Steel	Steel	Steel
JD YA7	Yale 1220		7		x		x	x			Steel	Steel	Steel

Steel= Steel, plated

Zinc= Pressure cast zinc, plated

## Lever styles

Standard cylinders shown, SFIC and FSIC also available.



Sparta



Rhodes



Athens



Tubular

## Finishes

Warm tone finishes



605  
Bright brass



606  
Satin brass



612  
Satin bronze



643e  
Aged bronze

Cool tone finishes



619  
Satin nickel



625  
Bright chrome

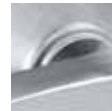

626  
Satin chrome



626AM  
Satin chrome with  
antimicrobial

Allegion, the Allegion logo, Schlage, the Schlage logo, Von Duprin, Falcon and Everest 29 are trademarks of Allegion plc, its subsidiaries and/or affiliates in the United States and other countries. All other trademarks are the property of their respective owners.

## About Allegion

Allegion (NYSE: ALLE) creates peace of mind by pioneering safety and security. As a \$2 billion provider of security solutions for homes and businesses, Allegion employs more than 8,000 people and sells products in more than 120 countries across the world. Allegion comprises 27 global brands, including strategic brands CISA®, Interflex®, LCN®, Schlage® and Von Duprin®. For more, visit [www.allegion.com](http://www.allegion.com).

aptiQ ■ LCN ■ SCHLAGE ■ STEELCRAFT ■ VON DUPRIN



© 2014 Allegion  
010432, Rev. 02/15  
[www.allegion.com/us](http://www.allegion.com/us)